

INSTALLATION INSTRUCTIONS – ROLLER SHADES

Tools Required:

Tape measure, pencil, drill, drill bits, screw driver, step stool.

Note: use a 5/64" drill bit to pre-drill the screw holes (for attachment to a wall stud or header board). Use a 1/4" drill bit for plastic anchors (for hollow dry wall or plaster mounting).

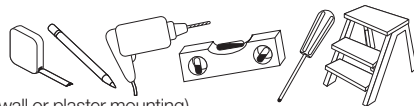

Step 1. Mount the Brackets

attach the brackets to the window frame, molding or ceiling as shown. The brackets are "universal" – there are no "right" and "left" brackets. Mark the screw locations with a pencil – pre-drill the screw holes using a 5/64" drill bit.

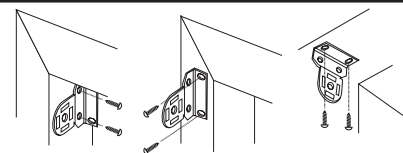

Step 2. Install the Shade

Put the spring loaded pin into the round hole of the bracket, push the spring loaded tip into the bracket, and then insert the hook arms on the opposite side of the shade into the two hook arm receiver holes of the bracket. Once the two hook arms are through the holes, gently pull down until the two hook arms have locked securely to the bracket. For cord control shades, the bottom of the clutch should always point straight down.

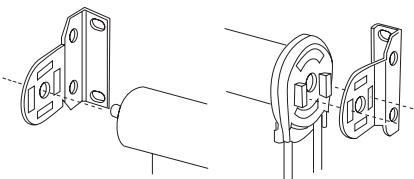

Step 3. Install the Bracket Covers

for Outside Mount shades only.

Bracket covers slide onto the bracket as shown until they snap into position.

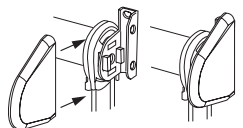

Step 4. Install the Tension Device – for Cord Control Shades

The tension device reduces the hazards of strangulation and entanglement of young children or pets by limiting access to the control cord. Anchor the Tension Device that is attached to the shade's control cord, to the window frame or wall, so that young children cannot pull the cord around their necks.

Lower the shade, and then position the Tension Device on the window frame or the wall so that the Tension Device and control cord do not interfere with raising and lowering the shade.

The Tension Device should be installed without stretching or pulling down on the control cord.

Stretching the control cord will cause excessive wear. Do not twist or cross the control cord.

Mark the screw hole locations with a pencil, then pre-drill the screw holes using a 3/32" drill bit. For hollow dry wall installation, use wall anchors (not included).

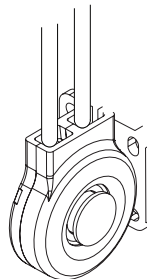

Operating the Shade

Cordless Shades

Raise the Shade: Grip the center of the bottom hem (do not release your grip until you have set the shade at the desired height) – pull the shade away from the window sill, if necessary – pull straight down to release the spring motor that controls the movement of the shade – allow it to rise to any desired point, then pull downward gently to stop/set the shade.

Lower the Shade: pull straight down and stop/set the shade as described above.

Adjusting Spring Roller Tension: to tighten (increase tension!), lower the shade about 18" from the top, and then remove the shade from the window brackets. Roll up the shade by hand, and then replace in the brackets. Repeat as necessary to get the desired tension.

To loosen (decrease tension!), raise the shade to the top, and then remove the shade from the brackets. Unroll the shade about 18", and then replace in the brackets.

The spring roller should not be too tight. Remember, when the window shade will not roll up, the spring is too loose. When it won't stay down, the roller spring is too tight.

Caution: over-winding may result in permanent damage.

Cord Control Shades

Pulling gently on the cord in one direction raises the shade; pulling it in the other direction lowers it. On shades where the fabric rolls against the window, the front cord does the raising. On shades where the fabric rolls toward the room, the rear cord does the raising.

Motorized Shades

See the separate sheet of instructions that describes the programming of the remote control(s).

Cleaning the Shades

Dusting: Vacuum using the soft brush attachment.

Washing: Use a cloth, sponge or soft brush and a mild detergent. Use warm or cold water, not hot water. Place towel on the floor or window sill and wash the blind in sections.

REPLACEMENT PARTS

In the event that replacement parts are ever needed, you may call: 1-800-264-1190

Please be sure to provide the following information, if possible:

- The complete model or catalog number of your product
- A description of the product
- A description of the part needed

LIMITED LIFETIME WARRANTY

Lifetime: Entire product against manufacturing defects (i.e. a flaw in the product design, materials or workmanship that causes the product to no longer function).

5 Years: All fabric

Not Covered: Normal Wear and Tear. Any product that fails due to:

- abuse
- exposure to salt air
- improper installation
- accident
- extraordinary use
- improper operation
- alteration
- improper cleaning
- misapplication
- damage from pests/insects/pets
- improper handling
- misuse

Costs associated with:

- product removal
- transportation to and from the retailer
- brand label removal
- product re-measure
- incidental or consequential damages
- product reinstallation
- shipping

To Report Shipping Damage

If damage occurred during shipping, call place of purchase and report within 7 calendar days or else you may be denied credit for your damaged product.

To Obtain Service

If you suspect that this Phase II product has a manufacturing defect in materials or workmanship:

1. Locate the sales receipt
2. Call place of purchase

Any unauthorized returns will not be accepted.

Warranty Remedy

THIS SHALL BE YOUR SOUL REMEDY UNDER THIS LIMITED WARRANTY.

If this product is found to have a manufacturing defect in materials or workmanship, we will, at our discretion, do one of the following:

- repair the product
- replace the product
- refund the cost of the product

Color

Colors vary from lot to lot and may not exactly match sample swatches or previous purchases.

Discontinued items or color selections will be replaced with the closest equivalent current product.

YOUR RIGHTS UNDER STATE LAW

This lifetime limited warranty gives you specific legal rights, and you may have other rights, which vary from state to state. Some states do not allow limitations on how long a warranty lasts, so the above limitations may not apply to you.

No agent, representative, dealer or unauthorized employee has the authority to increase or alter the obligation of this warranty.

This lifetime limited warranty supersedes any previous versions.